

SHTL SERIES

Single-Acting High Tonnage Lock-Nut Cylinders



Features

- Single acting, loads return.
- Special painted surface to increase corrosion resistance.
- Lock nut ensure the safety of long time load holding. All models include quick couplings (NPT3/8"-18) and dust-proof cap.
- Overflow port function could limit the stroke.
- The exclusive guide ring is designed absorbs eccentric loading without galling cylinder parts, reduces wear and extending life.
- Removable hardened saddles protect plunger during lifting and pressing.
- Double-acting mechanical lock nut cylinder could be customized.

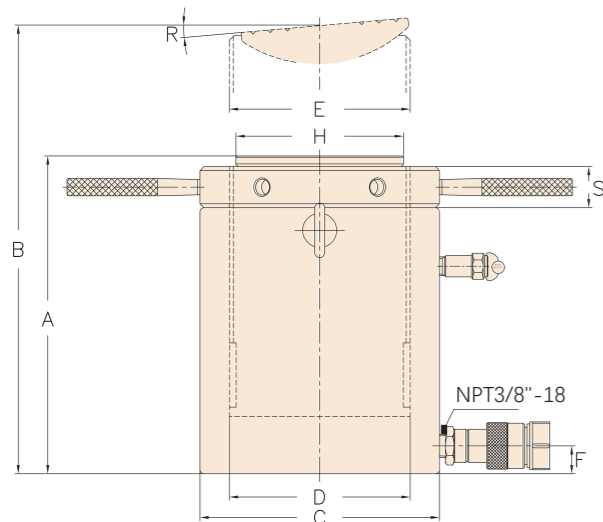

Capacity: 50-800tons
 Stroke: 1.97-11.81inch
 Max. Pressure: 10,000psi

Standard Features

- Lock nut ensure the safety of long time load holding.
- Top and side mounted lifting eyes.
- Overflow port function could limit the stroke.
- QCS-A-NPT3/8 coupler and dustcap.

Pump Selection

Selection appropriate pumps for offer optimum combination. For details, please refer to the section " hydraulic pumps ".



Hoses

Select AIPI high quality high pressure hoses. For details, please refer to the section " hydraulic components ".



Low Profile Lock-Nut Cylinders

When low height with high force is required, pancake cylinders with lock nut offer the solution to lift the first few centimetres.



Integrated Tilt Saddles

ALL SHTL-Series cylinders include integral tilt saddles with maximum tilt angles up to 5° .



Cylinder Capacity	Stroke	Model Number	Cylinder Effective Area	Oil Capacity	Collapsed Height			Cylinder Bore Dia.	Plunger Diameter (Thread)	Base to Advance Port	Saddle Dia.	Saddle Max. Tilt Angle	Lock Nut Height	Weight
					A	B	C							
ton(max)	(inch)		(in ²)	(in ³)	(inch)	(inch)	(inch)	(inch)	(mm)	(inch)	(inch)	(inch)	(inch)	(lbs)
50 (55)	1.97	SHTL50-50	12.17	23.9	7.56	8.27	5.5	3.94	Tr99x4	0.94	3.54	5°	1.18	40
	3.94	SHTL50-100	12.17	47.8	9.53	12.40	5.5	3.94	Tr99x4	0.94	3.54	5°	1.18	55
	5.91	SHTL50-150	12.17	71.8	11.50	16.73	5.5	3.94	Tr99x4	0.94	3.54	5°	1.18	73
	7.87	SHTL50-200	12.17	95.7	13.46	21.54	5.5	3.94	Tr99x4	0.94	3.54	5°	1.18	90
	11.81	SHTL50-300	12.17	143.5	17.40	29.41	5.5	3.94	Tr99x4	0.94	3.54	5°	1.18	117
100 (107.7)	1.97	SHTL100-50	23.85	47.0	6.70	8.66	7.4	5.51	Tr139x6	1.02	5.12	5°	1.57	75
	3.94	SHTL100-100	23.85	94.0	10.35	14.06	7.4	5.51	Tr139x6	1.02	5.12	5°	1.57	110
	5.91	SHTL100-150	23.85	141.0	12.32	18.20	7.4	5.51	Tr139x6	1.02	5.12	5°	1.57	134
	7.87	SHTL100-200	23.85	188.0	14.29	22.44	7.4	5.51	Tr139x6	1.02	5.12	5°	1.57	161
	11.81	SHTL100-300	23.85	281.9	18.23	30.31	7.4	5.51	Tr139x6	1.02	5.12	5°	1.57	205
150 (158.8)	1.97	SHTL150-50	35.17	69.2	8.23	10.20	9.0	6.70	Tr159x6	1.93	6.30	5°	1.50	123
	3.94	SHTL150-100	35.17	138.5	10.20	14.13	9.0	6.70	Tr159x6	1.93	6.30	5°	1.50	154
	5.91	SHTL150-150	35.17	207.7	12.17	18.07	9.0	6.70	Tr159x6	1.93	6.30	5°	1.50	183
	7.87	SHTL150-200	35.17	276.9	14.13	22.01	9.0	6.70	Tr159x6	1.93	6.30	5°	1.50	214
	11.81	SHTL150-300	35.17	415.3	18.07	29.88	9.0	6.70	Tr159x6	1.93	6.30	5°	1.50	273
200 (219.8)	1.97	SHTL200-50	48.67	95.8	9.57	11.54	10.6	7.87	Tr199x6	2.00	7.32	5°	2.05	205
	5.91	SHTL200-150	48.67	287.5	13.50	19.41	10.6	7.87	Tr199x6	2.00	7.32	5°	2.05	289
	11.81	SHTL200-300	48.67	575.0	19.41	31.22	10.6	7.87	Tr199x6	2.00	7.32	5°	2.05	417
300 (343.4)	1.97	SHTL300-50	76.04	149.7	11.61	13.58	12.6	9.84	Tr249x6	2.32	9.30	5°	2.36	395
	5.91	SHTL300-150	76.04	449.1	15.55	21.46	12.6	9.84	Tr249x6	2.32	9.30	5°	2.36	529
	11.81	SHTL300-300	76.04	898.1	21.46	33.27	12.6	9.84	Tr249x6	2.32	9.30	5°	2.36	730
400 (430.8)	1.97	SHTL400-50	95.40	187.8	13.19	15.16	14.57	11.00	Tr279x6	2.76	10.08	5°	2.76	586
	5.91	SHTL400-150	95.40	563.3	17.13	23.03	14.57	11.00	Tr279x6	2.76	10.08	5°	2.76	761
	11.81	SHTL400-300	95.40	1126.6	23.03	34.84	14.57	11.00	Tr279x6	2.76	10.08	5°	2.76	1023
500 (511.4)	1.97	SHTL500-50	124.60	245.3	14.76	16.73	16.5	12.60	Tr319x6	3.15	12.05	5°	3.15	789
	5.91	SHTL500-150	124.60	735.8	18.70	24.61	16.5	12.60	Tr319x6	3.15	12.05	5°	3.15	1001
	11.81	SHTL500-300	124.60	1471.5	24.61	36.42	16.5	12.60	Tr319x6	3.15	12.05	5°	3.15	1316
600 (630)	1.97	SHTL600-50	157.70	310.4	15.55	17.52	19.7	14.17	Tr359x6	3.35	13.62	5°	3.35	1080
	5.91	SHTL600-150	157.70	931.3	19.50	25.40	19.7	14.17	Tr359x6	3.35	13.62	5°	3.35	1354
	11.81	SHTL600-300	157.70	1862.6	25.39	37.20	19.7	14.17	Tr359x6	3.35	13.62	5°	3.35	1764
800 (879)	1.97	SHTL800-50	194.68	383.2	17.91	19.88	21.7	15.75	Tr399x6	3.94	15.20	5°	3.94	1858
	5.91	SHTL800-150	194.68	1149.7	21.85	27.76	21.7	15.75	Tr399x6	3.94	15.20	5°	3.94	2266
	11.81	SHTL800-300	194.68	2300.5	27.76	39.57	21.7	15.75	Tr399x6	3.94	15.20	5°	3.94	2879